

FIRST FLOOR

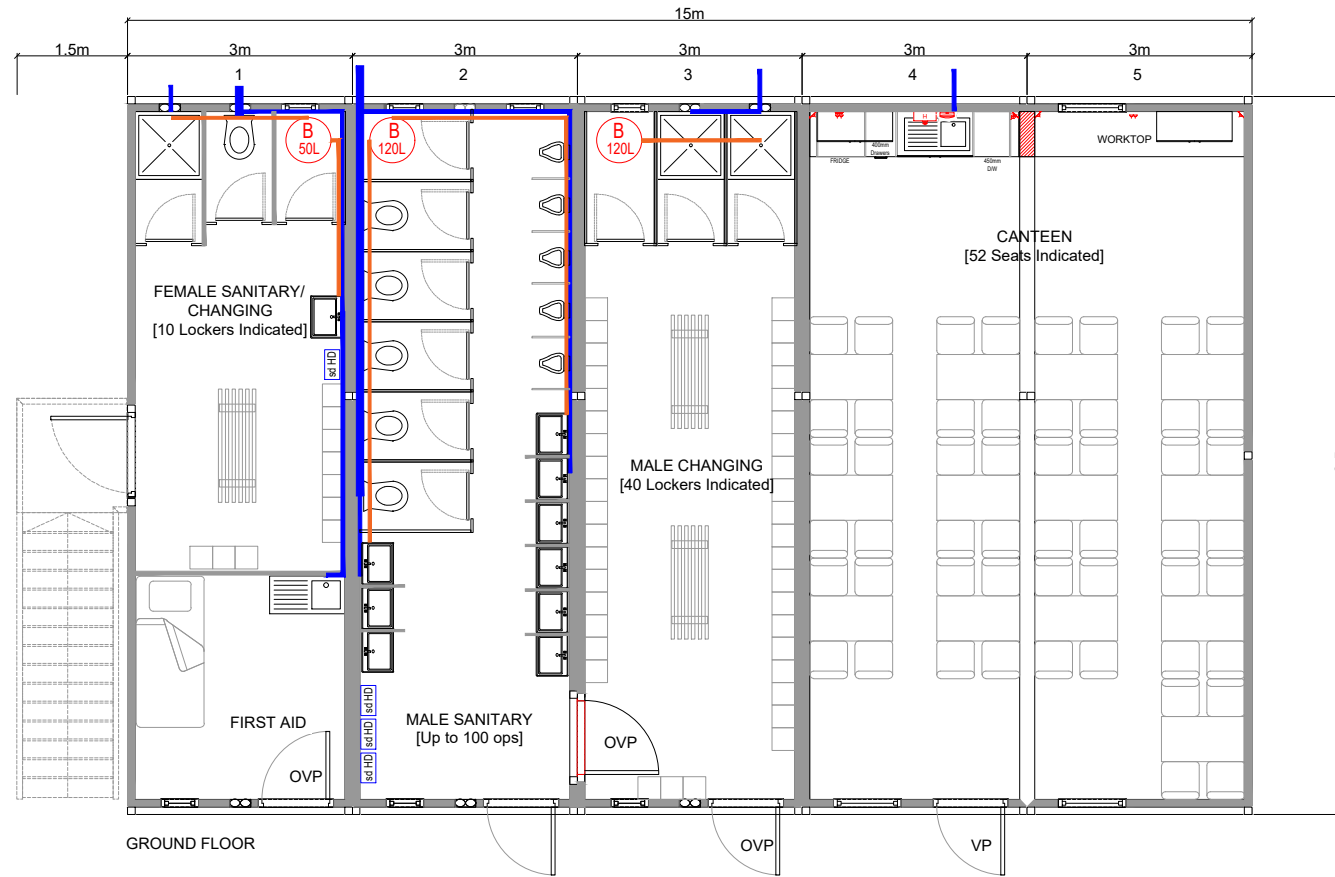

GROUND FLOOR

MODULAR ACCOMODATION SPECIFICATION

Number of Units:	10
Number of Storeys:	2
Region:	X
I/E/J/V:	X
Number of Ops:	50
Number of Staff:	16

NOTES

All furniture shown for information only.
Do not scale from drawing.

Standard stair pod footprint is 2.5x4.8m Stair pod roof sizes vary from partial (2.5x1.2m*) to full coverage (2.5x4.8m*).
*approximate dimensions

All standard fitted floor covering is vinyl.
Carpet can be quoted on request on a m² basis.

C1	PRELIMINARY FOR DISCUSSION ONLY- MALE SANITARY REDRAWN	12/05/21
R2	M&E ADDED	CA
CA		
A1	PRELIMINARY FOR DISCUSSION ONLY- DOOR ADDED TO SANITARY UNIT REVISION TO MALE CHANGING ROOM	18/05/21
R2		CA
CA		
P1	PRELIMINARY FOR DISCUSSION ONLY:	27/04/21
R2		CA
CA		
Revision Originator	Description (Purpose of Issue)	Date
Checker	Revision Items	Authoriser

Originator:

SELECT PLANT HIRE COMPANY LIMITED

Logo:



Address:
Select Plant Hire Company Ltd.,
19 Wincham Lane,
Wincham,
Cheshire,
CW9 6DE.

Contact Details:
T: Telephone: +44 (0)845 873 5936
F: Fax: +44 (0)1777 353026

Client:

Select Plant

Project:

Standard Hire Fleet

Drawing Title:

Plan Layout

Drawing/Quote Number:

50n5 Layout

Scale At A3:

NTS

Filename:

50n5 Layout

Revision

C1